

# The Obama Building

22000 GRAND RIVER AVENUE, DETROIT

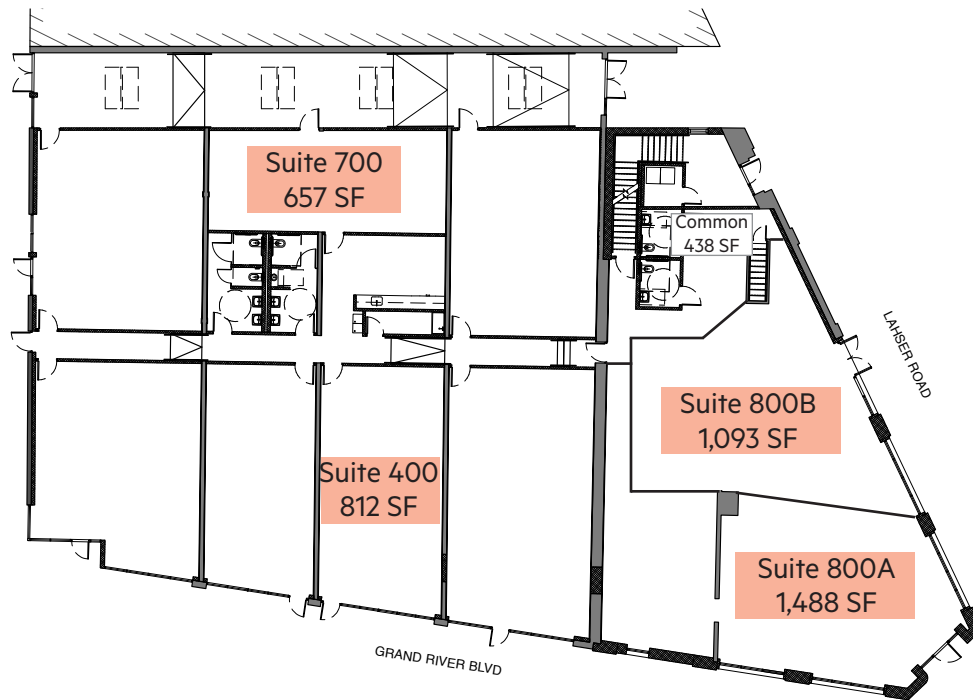

## NEIGHBORHOOD

Old Redford

## BUILDING TYPE

Residential + Retail

## COMPLETION

November 2020

## SIZE

Suite 400 - 812 SF  
Suite 700 - 657 SF  
Suite 800 - 2,990 SF  
800A - 1,488 SF  
800B - 1,093 SF  
Common 438 SF

## SUITE HIGHLIGHTS

Signage opportunities  
HVAC and electric installed  
12' ceiling  
Storage available

## BUILDING HIGHLIGHTS

Fully restored historic building  
Premier location and visibility  
Strong community  
Access to public transportation

## BUILDING TENANTS

Tax services  
Health and wellness  
Social services agency  
Photography  
Nail salon

## AREA BUSINESSES

Historic theatre  
Artist village  
Coffee shop  
Restaurants  
Banks  
Grocery  
Public Library